



THANK YOU FOR BUYING A HOTPOINT PRODUCT.
In order to receive a more complete assistance, please register your appliance on: www.hotpoint.eu/register

PLEASE SCAN THE QR CODE ON YOUR APPLIANCE IN ORDER TO HAVE MORE DETAILED INFORMATION



Before using the appliance carefully read Safety Instructions guide.

CONTROL PANEL

1. On-Off/Reset button with indicator light
2. Program selection button with indicator light
3. Half Load button with indicator light
4. Rinse Aid refill indicator light
5. Salt refill indicator light
6. Program indicator lights
7. Delay indicator light
8. Delay button with indicator light
9. Tablet (Tab) button with indicator light
10. Start/Pause button with indicator light / Drain out

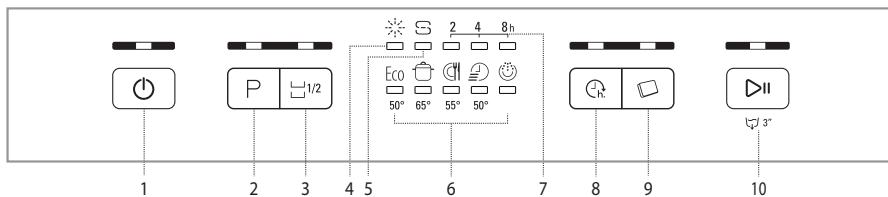

FIRST TIME USE

FILLING THE SALT RESERVOIR

The use of salt prevents the formation of LIMESCALE on the dishes and on the machine's functional components.

- It is mandatory that **the salt reservoir never be empty.**
- It is important to set the water hardness.

The salt reservoir is located in the lower part of the dishwasher and must be filled when the **SALT REFILL indicator light** in the control panel is lit.

1. Remove the lower rack and unscrew the reservoir cap (anticlockwise).
2. Position the funnel (see figure) and fill the salt reservoir right up to its edge (approximately 1 kg); it is not unusual for a little water to leak out.
3. **Only the first time you do this: fill the salt reservoir with water.**

4. Remove the funnel and wipe any salt residue away from the opening. Make sure the cap is screwed on tightly, so that no detergent can get into the container during the wash program (this could damage the water softener beyond repair).

Whenever you need to add salt, it is mandatory to complete the procedure before the beginning of the washing cycle to avoid corrosion.

FILLING THE RINSE AID DISPENSER

1. Rinse aid makes dish DRYING easier. The rinse aid dispenser **A** should be filled when the **RINSE AID REFILL indicator light** in the control panel is lit. **NEVER pour the rinse aid directly into the appliance tub.**

PROGRAMS TABLE

| Program | Programs description | Drying phase | Available options *) | Duration of wash program (h:min)**) | Water consumption (litres/cycle) | Energy consumption (kWh/cycle) |
|-------------------------|---|--------------|----------------------|-------------------------------------|----------------------------------|--------------------------------|
| 1. Eco 50° | Eco 50°- Eco program is suitable to clean normally soiled tableware, that for this use, it is the most efficient program in terms of its combined energy and water consumption, and that it is used to assess compliance with the EU Ecodesign legislation. | ✓ | | 3:35 | 9.5 | 0.95 |
| 2. Intensive 65° | Program recommended for heavily soiled crockery, especially suitable for pans and saucepans (not to be used for delicate items). | ✓ | | 2:40 | 18.0 | 1.60 |
| 3. Mixed 55° | Mixed soil. For normally soiled dishes with dried food residues. | ✓ | | 2:15 | 16.0 | 1.40 |
| 4. Rapid 28' 50° | Program to be used for half load of lightly-soiled dishes with no dried food residues. Does not include drying phase. | - | | 0:28 | 9.0 | 0.50 |
| 5. Soak | Use to refresh crockery planned to be washed later. No detergent to be used with this program. | - | | 0:12 | 4.7 | 0.01 |

Eco program data is measured under laboratory conditions according to European Standard EN 60436:2020.

Note for Test Laboratories:

For information on comparative EN testing conditions, please send an email to the following address: dw_test_support@whirlpool.com

Pre-treatment of the dishes is not needed before any of the programs.

*) Not all options can be used simultaneously.

**) Values given for programs other than the program Eco are indicative only. The actual time may vary depending on many factors such as temperature and pressure of the incoming water, room temperature, amount of detergent, quantity and type of load, load balancing, additional selected options and sensor calibration. The sensor calibration can increase program duration up to 20 min.

OPTIONS AND FUNCTIONS

Please scan the QR code on your product in order to have more detailed information.

OPTIONS can be selected directly by pressing the corresponding button (see CONTROL PANEL). If an option is not compatible with the selected program (see PROGRAMS TABLE), the corresponding LED flashes rapidly 3 times and beeps will sound. The option will not be enabled.

 **DELAY** - It is possible to delay the start time of the program by **2, 4 or 8** hours. **The DELAY function cannot be set once a program cycle has been started.**

 **TABLET (Tab)** - If you use powder or liquid detergent, this option should be off.

 **1/2 HALF LOAD** - If there are not many dishes to be washed, a half load cycle may be used in order to save water, electricity and detergent. **Remember to halve the amount of detergent.**

 **DRAIN OUT** - To stop and cancel the active cycle, the DRAIN OUT function can be used.

A long press of START/PAUSE button, will activate the DRAIN OUT function. The active program will be stopped and the water in the dishwasher will be drained out.

LOADING THE RACKS

CAPACITY: **14** standard place-settings

UPPER RACK

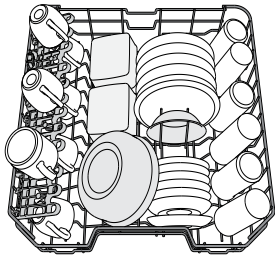

(loading example for the upper rack)

Load delicate and light dishes: glasses, cups, saucers, low salad bowls.

LOWER RACK

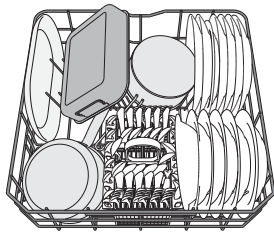

(loading example for the lower rack)

For pots, lids, plates, salad bowls, cutlery etc.. Large plates and lids should ideally be placed at the sides to avoid interferences with the spray arm.

FOLDABLE FLAPS WITH ADJUSTABLE POSITION

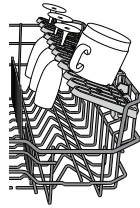

CUTLERY BASKET

The basket is equipped with top grilles for improved cutlery arrangement. The cutlery basket should be positioned only at the front of the lower rack.

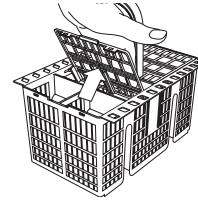

Knives and other utensils with sharp edges must be placed in the cutlery basket with the points facing downwards or they must be positioned horizontally in the tip-up compartments on the upper rack.

CLEANING AND MAINTENANCE

More information in the Daily Reference Guide on website.

CLEANING THE FILTER ASSEMBLY

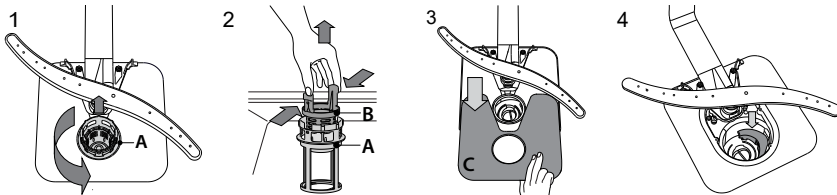

In case you find foreign objects (such as broken glass, porcelain, bones, fruit seeds etc.) **please remove them carefully.** **NEVER REMOVE** the wash-cycle pump protection (black detail) (Fig 4).

CLEANING THE SPRAY ARMS

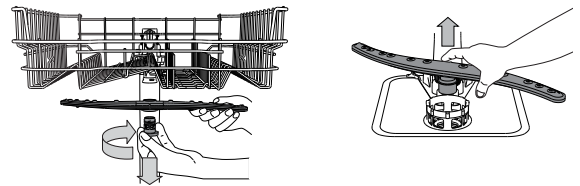

To remove the upper spray arm, turn the plastic locking ring in a clockwise direction.

The lower spray arm may be removed by pulling it upwards.

Policies, standard documentation, ordering of spare parts and additional product information can be found by:

- Using QR code on your product.
- Visiting our website docs.hotpoint.eu and parts-selfservice.whirlpool.com
- Alternatively, **contact our After-sales Service** (See phone number in the warranty booklet). When contacting our After-sales Service, please state the codes provided on your product's identification plate.

The model information can be retrieved using the QR-Code reported in the energy label. The label also includes the model identifier that can be used to consult the portal of the registry at <https://eprel.ec.europa.eu>.

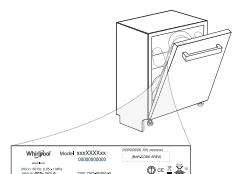

400011656914B

01/2023 dk - Xerox Fabriano

